

Head

Assembly Part No: 419

POS	PART NUMBER	DESCRIPTION	#
1	VP00466 AUS	ELECTRIC CORD 3X1 & PLUG	1
2	VP00138	CABLE SLEEVE	1
3	VP01006	SCREW 5X20	2
4	VP00139	CABLE CLAMP	1
5	VP02997	HANDLE	1
6	VP01006	SCREW 5X20	4
7	VP00137	COVER AMSTERDAM	1
8	VP01006	SCREW 5X20	2
10	VP00450	TERMINAL BOARD 2 POLES	1
11	VP00141 RA	COVERING A.300 AMSTERDAM RED	1
12	VP01006	SCREW 5X20	5
13	VP00326	ANTISPLASH SWITCH	1
14	VP01006	SCREW 5X20	4
15	VP03969	WASHER H8 D85X65	1
16	VP01005	SCREW 5X14	2
17	VP03900	FOAM FILTER	1
18	VP03608	MOTOR MOUNTING WET	1
20	VP03901	MOTOR GASKET	1
21	VP03890 S	MOTOR 1200 W	1
22	VP03901	MOTOR GASKET	1
23	VP03866	WASHER 65MM	1
24	VP00120 G	MOTOR MOUNTING BASE with GASKET	1
25	VP03307	CABLE HOOK	1
26	VP01979	SCREW 5X25	1
43	VP02184	ADD.SOCKET PROTECTION	1
44	VP00098	ADDITIONAL SOCKET SCREWED	1
45	VP01044	SCREW M 3X10	2
46	VP01046	NUT 3 MA	2
*	VP01101	CONNECTING WIRES	2
*	VP01103	FASTENER	2
*	VP01106	CLIP	1

Filter

Assembly Part No: 4244

POS	PART NUMBER	DESCRIPTION	#
1	VP03706	PLASTIC SLEEVE D.8	4
2	VP03724	SCREW SS 5X25 PHILLIPS ANTIFOAM	4
3	VP02823	ANTI FOAM BODY 99	1
4	VP03138	FILTER NET 0,4 D.90 H=45	1
5	VP02676	HIGHER FLOAT 99	1
6	VP00123	FILTER RING 300	1
7	VP02860	FILTER CONICAL POLY. 300	1
8	VP02859	BASKET CONICAL 300	1

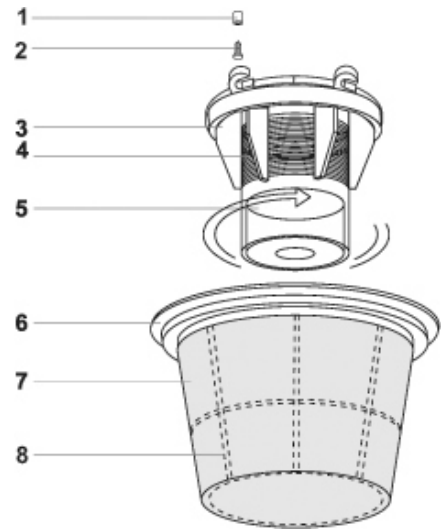
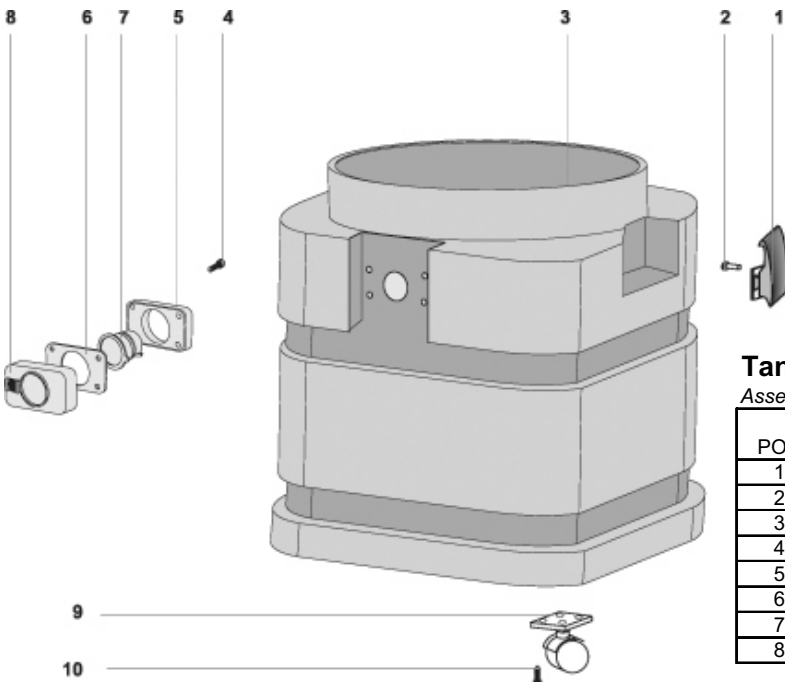

Tank

Assembly Part No: 2221

POS	PART NUMBER	DESCRIPTION	#
1	VP01847	HOOK PLASTIC COMPLETE	2
2	VP01300	RIVET 5X24,5	4
3	VP02028	PLASTIC TANK 300/S	1
4	VP01050	SCREW 5X35	4
5	VP02586	GASKET R 205	1
6	VP02846	GASKET D.38	1
7	VP02593	DEFLECTOR	1
8	VP02652 A	COMPLETE INLET MACHINE END	1